

EKI-2701PSI

Industrial PoE Splitter with Wide Temperature



Features

- Supports 10/100/1000 Base-TX for PoE in and Data out
- IEEE 802.3af compliant split power/data from PoE equipment
- Power isolation and short circuit protection for power output
- Supports output power up to 12.95 W at 24 V_{DC}
- Provides slim size and DIN-rail/Wall mount with IP30 metal mechanism
- Supports operating temperatures from -40 to 75°C

Introduction

With the technology of PoE (Power over Ethernet), we can transfer both data and electrical power to Ethernet-enabled devices using a standard Ethernet CAT5 cable, EKI-2701PSI plays the role of powered device (PD) and splits power from PoE to Ethernet devices. In this case, both power and data can be transmitted up to 328 feet (100m) from power source equipment (PSE). This product can operate in a wide range of temperature between -40 and 75°C, and the rugged hardware design makes EKI-2701PSI perfect to ensure your PoE Ethernet equipment can meet industrial applications demanding.

Specifications

Communications

- **Standard** IEEE 802.3, 802.3u, 802.3af, 802.3ab
- **LAN** 10/100/1000 Base-TX
- **Transmission Distance** Up to 100 m
- **Transmission Speed** up to 1000 Mbps

Interface

- **Connectors** PoE IN: RJ-45
DATA OUT: RJ-45
6-pin removable screw terminal (power output)
- **LED Indicators** Power
Link/Activity, Duplex/Collision

Power

- **Power Consumption** Max. 17.76 W
- **Power Input** 44 ~ 57 V_{DC}
- **Power Output** 12.95 W @ 24 V_{DC}

Mechanism

- **Dimensions (W x H x D)** 37 x 140 x 95 mm (1.46" x 5.51" x 3.74")
- **Enclosure** IP30, Metal shell with solid mounting kits
- **Mounting** DIN-rail, Wall

Protection

- **Overload current** Present

Environment

- **Operating Temperature** -40 ~ 75°C (-40 ~ 167°F)
- **Storage Temperature** -40 ~ 85°C (-40 ~ 185°F)
- **Operating Humidity** 5 ~ 95% (non-condensing)
- **Storage Humidity** 0 ~ 95% (non-condensing)
- **MTBF** 440,132 hours

Certifications

- **Safety** UL 60950-1, CAN/CSA-C22.2 No.60950
- **EMI** FCC Part 15 Subpart B Class A, EN 55022 Class A
- **EMS** EN 61000-4-2
EN 61000-4-3
EN 61000-4-4
EN 61000-4-5
EN 61000-4-6
EN 61000-4-8
- **Shock** IEC 60068-2-27
- **Freefall** IEC 60068-2-32
- **Vibration** IEC 60068-2-6

Dimensions

Unit: [mm]

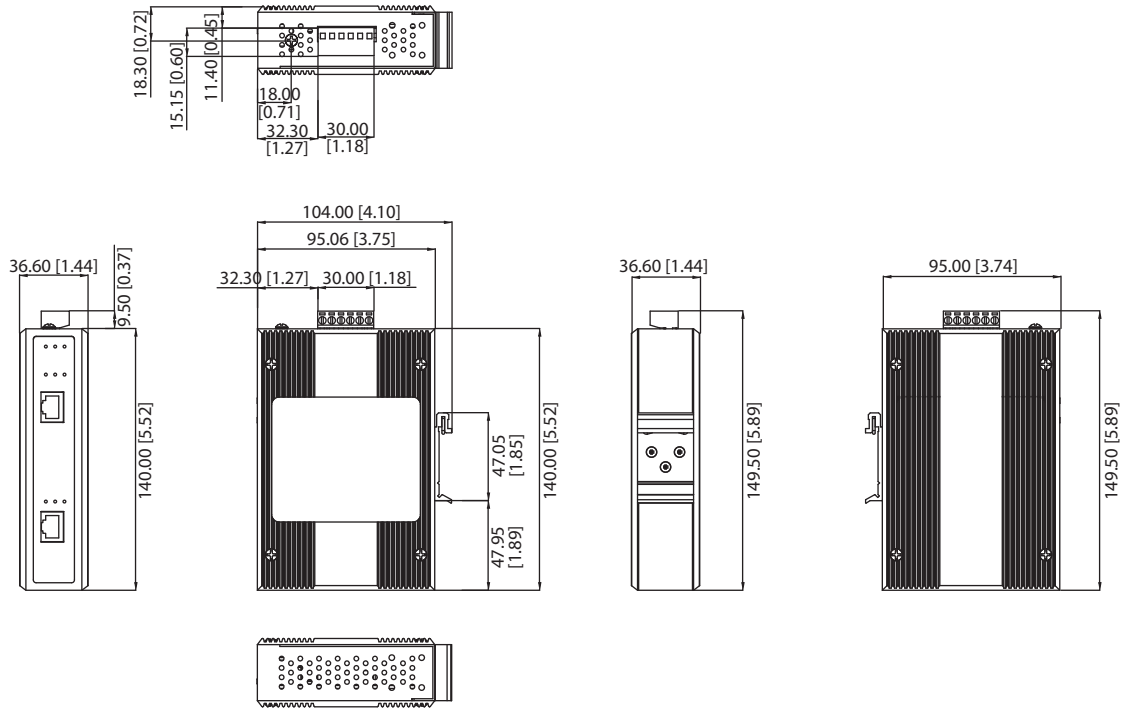

Panel Cut-out Dimensions: 104 x 140 x 36.6 mm (4.1" x 5.52" x 1.44")

Ordering Information

- EKI-2701PSI PoE Splitter w/ Wide Temp



www.L-TronDirect.com

800-830-9523

info@L-Tron.com

596 Fishers Station Dr | Victor, NY | 14564 | Suite 1 A

www.L-Tron.com

